

EVOLVE EDUCATE ENGAGE



The Royal Australasian
College of Physicians

RACP
Congress
16 – 18 May 2016

Delegate
Handbook

 /theRACP
#RACPCongress16

 @theRACP
#RACPCongress16

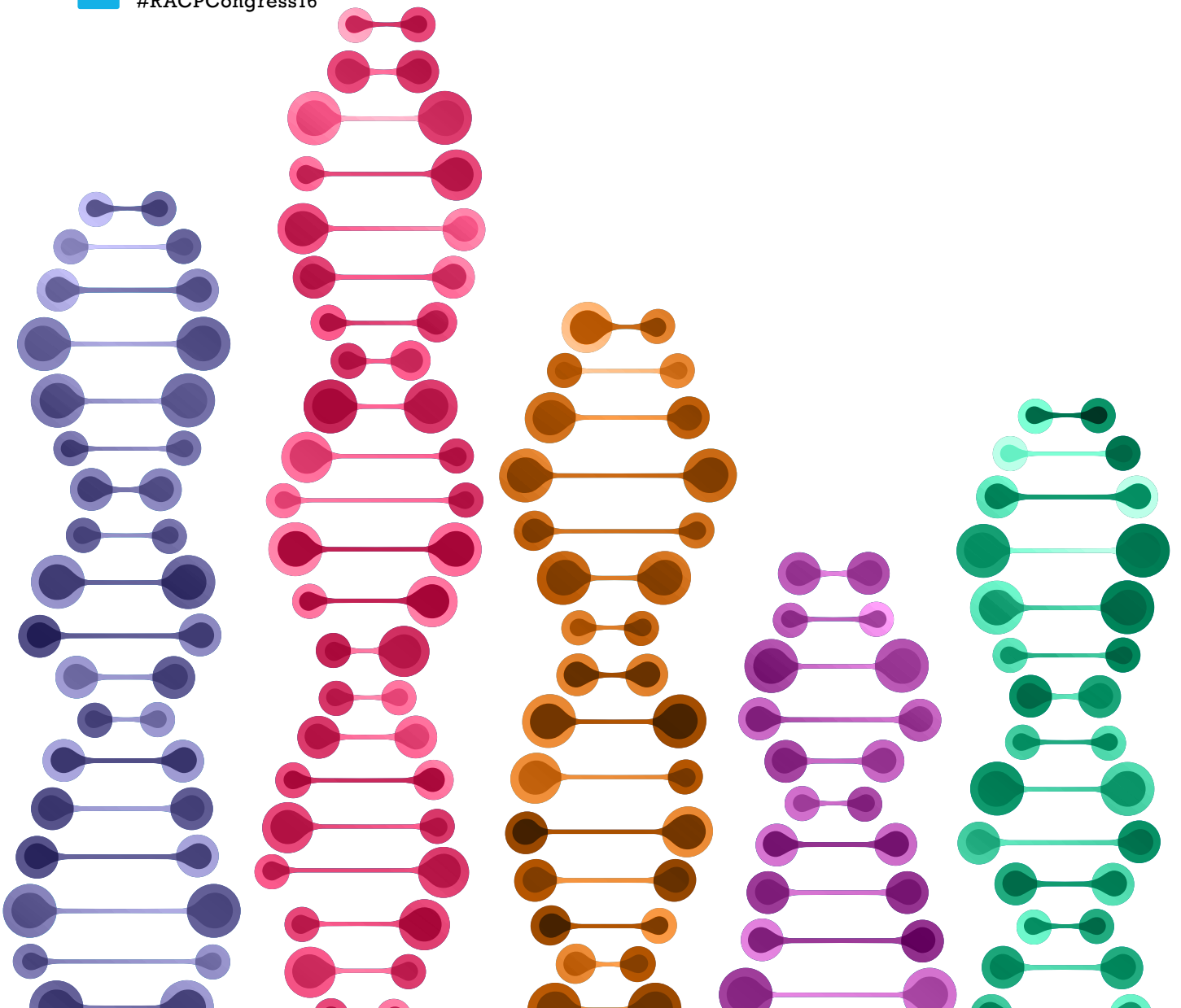

Contents

Congress Partners	02	Program	11
President's Welcome Message	03	Poster Boards	32
Host	03	Supporting, Encouraging and Acknowledging Excellence Through the RACP Foundation	34
Congress Committee	04	General Information	35
RACP Congress 2016 App	05	Emergency & Evacuation Procedures	37
Congress 2016 Abstract Online Supplement	05	Evacuation Maps	38
Registration	06	Exhibition	39
Congress Information	07	Venue Floor Plans	40
Oration Speakers	08		

Congress Partners

The Congress gratefully acknowledges the following for their support.



Australian Government
Department of Veterans' Affairs



Australian Government
Department of Health
Therapeutic Goods Administration

President's Welcome Message



Dear Colleagues

On behalf of the Board of The Royal Australasian College of Physicians and the Congress Organising Committee, I welcome you to Adelaide, South Australia, for the RACP Congress 2016 – Evolve, Educate, Engage.

This year's event includes over 100 presentations and panel discussions from all Divisions, Faculties, Chapters and many specialty societies encompassing topics such as end-of-life care, clinical genetics, adolescent sexual health and the College's Evolve initiative.

This year we are pleased to be hosting a number of highly respected keynote speakers at Congress including:

- Sir Harry Burns (United Kingdom)
- Professor William Glass, Ferguson-Glass Oration
- Professor John Mills, Priscilla Kincaid-Smith Oration
- Dr Sue Morey, Redfern Oration
- Professor Dinah Reddihough, Howard Williams Oration
- Professor John Chalmers, Cotterell Memorial Oration

I would like to thank all our speakers, session chairs, sponsors and exhibitors for their contributions to the Congress. I encourage all delegates to take advantage of the opportunities on offer, including workshops and the Professional Development stream, and to take the time to network with peers across specialities and from across the healthcare professions.

I look forward to seeing you over the next few days and I hope you enjoy this year's Congress.

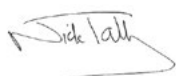

Laureate Professor Nicholas Talley
RACP President

Host

The Royal Australasian College of Physicians (RACP) connects, represents and trains over 15,000 physicians and 7,500 trainee physicians in Australia and New Zealand.

For more information go to www.racp.edu.au

The Royal Australasian College of Physicians unifies the major medical specialties across both countries to promote excellence in health.

Through the College, our members come together to invest their time and expertise to:

- **Educate** the next generation of specialists to deliver quality care for patients and promote excellence in their profession. Our CPD and Next Generation Learning initiatives also provide members with opportunities to develop their skills as both practitioners and educators.
- **Advocate** for policies that promote the interests of our profession, our patients and our communities. Our policy and advocacy work provides a voice for our specialties in the debates that will shape our health system and our broader society.
- **Innovate** in the delivery of specialist medicine in a constantly changing world. We support research in our specialties with our grants program, while initiatives like Evolve evaluate the evidence to ensure our practice is at the cutting edge of medical science.

Congress Committee

Lead Fellow

Associate Professor Michael Gabbett

College Education Committee Representative

Associate Professor Mitra Guha

Adult Medicine Division Representative

Professor Bill Heddle

College Policy & Advocacy Committee Representative

Associate Professor Alasdair MacDonald

Paediatric & Child Health Representative

Dr Nicki Murdock

Australasian Faculty of Public Health Medicine

Representative

Dr Greg Stewart

South Australian Committee Representative

Dr David Thomas

Australasian Faculty of Occupational and Environmental
Medicine Representative

Dr John Wilson



TAKE THE NEXT STEP IN YOUR CAREER.

Monash University's School of Public Health and Preventive Medicine (SPHPM) is the top choice for clinical research methods training; no other Victorian university offers this niche program, taught by leading clinical academics.

Our Clinical Research Methods postgraduate courses are the stepping-stone for physicians, clinicians, doctors and many other health-related professions to propel their careers and clinical leadership opportunities in a competitive industry, as well as a pathway into research.

Study with us to gain key research knowledge and skills that complement and optimise clinical practice.

For more information about our Clinical Research Methods courses and the benefits of studying at Monash visit monash.edu.au/sphpm/crm or call +61 3 9903 0563



RACP Congress 2016 App

Download the RACP Congress 2016 app for all information including program, speakers and exhibitors.

The free Congress app is available for both iPhone and Android via the app stores.

Your personal login for the app is your registered email address for the Congress. The password is '2016'. If you require any assistance, please visit the onsite Registration Desk.

Congress 2016 Abstract Online Supplement

Visit the RACP Congress 2016 abstracts page on the website www.racpcongress2016.com to access presentation abstracts.

Are you looking to change the direction of your medical career?

CHG is celebrating our 40th year in the occupational medicine industry and we are looking for skilled professionals to join our team.

CHG is a South Australian owned and operated small to medium sized enterprise, with 40 years' experience delivering innovative and leading practice industry solutions to address the occupational health needs of Australian employers.

The integration of CHG's broad scope of services provides employers with a unique, holistic and integrated approach.

<div style="display: flex; align-items: center;"> <div style="writing-mode: vertical-rl; transform: rotate(180deg); font-weight: bold; margin-right: 5px;">CHG</div> <div style="flex-grow: 1;"> <p>CHG operates three medical clinics in metropolitan Adelaide at Mile End, Gillman and Elizabeth Vale.</p> <p>Mission: To partner with our clients to make a difference in people's working lives by improving wellbeing, preventing injury, increasing health and safety awareness and restoring and maintaining health.</p>  </div> </div>	<p>ARE YOU A SKILLED PROFESSIONAL?</p> <p>Opportunities exist for:</p> <ul style="list-style-type: none"> • Occupational Physicians • Doctors • Nurses • Physiotherapists • Occupational Therapists 
<div style="display: flex; align-items: center;"> <div style="writing-mode: vertical-rl; transform: rotate(180deg); font-weight: bold; margin-right: 5px;">CHG DEFENCE</div> <div style="flex-grow: 1;"> <p>CHG Defence is the national provider of specialised medical examinations for candidates seeking to join the Australian Defence Force (ADF). CHG Defence operates from 16 centres in capital and regional cities nation wide.</p> <p>Mission: To recruit the right people in the right numbers at the right time for the ADF in order to build and sustain Defence capability.</p>  </div> </div>	<p>BENEFITS OF WORKING FOR CHG:</p> <ul style="list-style-type: none"> • Flexible working hours • Competitive remuneration and opportunities to revenue share in many roles • Professional development support both internally and externally • Multidisciplinary environment

Contact us to discuss our unique opportunities recruitment@chg.net.au or visit www.chg.net.au

Registration

The RACP Congress 2016 Registration Desk is located on the ground level of the west entrance to the Adelaide Convention Centre and is open as follows:

Sunday, 15 May
7am – 5pm

Monday, 16 May
7am – 5pm

Tuesday, 17 May
6.30am – 5pm

Wednesday, 18 May
6.30am – 12.30pm

Speakers Preparation Room

Speakers are asked to submit their presentation to the technicians in the Speakers' Preparation Room at their earliest convenience and no later than two hours prior to the start of their session.

The Speakers' Preparation Room is located in room L1b (opposite the Registration Desk) at the Adelaide Convention Centre and is open as follows:

Saturday, 14 May
2.30pm – 4.30pm

Sunday, 15 May
7am – 4pm

Monday, 16 May
7am – 5.30pm

Tuesday, 17 May
7am – 5.30pm

Wednesday, 18 May
7am – 11.30am

Name Badge and Social Function Tickets

Your name badge is your entry to all sessions, the exhibition, inclusive social functions as well as morning and afternoon teas and lunches. Your nominated functions are listed on the back of your name badge. Please wear your name badge at all times. The swapping of the Congress lanyard with your own lanyard is not permitted.

Certificates of Attendance

Following the Congress all registered delegates will receive a Certificate of Attendance via email.

Delegate List

The Delegate List contains the name, organisation and country of origin of registered delegates and registered exhibitors.

Continuing Professional Development Credits

RACP Congress is a valuable learning opportunity and participation counts towards your annual CPD requirements.

This year the College Board have increased the CPD credits per hour that can be accumulated for attendance at RACP Congress 2016.

In 2016 attendees can claim two credits per hour under MyCPD Category 2: Group Learning Activities (up to the cap of 50 credits).

Congress Information

Networking and social functions

Australasian Faculty of Occupational and Environmental Medicine Annual Training Meeting Dinner

Date: Saturday, 14 May 2016
Time: 7pm – 10pm
Venue: The Sanctuary, Adelaide Zoo, Frome Road, Adelaide
Cost: AUD \$132 per person
Transfers: Departing from the Adelaide Convention Centre at 6.30pm sharp

Chapter of Community Child Health Dinner

Date: Sunday, 15 May 2016
Time: 7pm – 10pm
Venue: Parlamento
Cost: AUD \$50 per person (does not include beverages or transfers – cash bar available)

Trainees' Dinner

Date: Sunday, 15 May 2016
Time: 7pm – 10pm
Venue: Belgian Beer Cafe
Cost: AUD \$55 per person (does not include beverages or transfers – cash bar available)

Welcome Reception

Date: Monday, 16 May 2016
Time: 5pm – 6.30pm
Venue: Exhibition Hall, Adelaide Convention & Exhibition Centre
Cost: Included in all full registrations.
Day registration and guest tickets: AUD \$88

Australasian Faculty of Occupational and Environmental Medicine Dinner

Date: Monday, 16 May 2016
Time: 7pm – 10pm
Venue: Red Ochre Grill
Cost: AUD \$120 per person
Transfers: Departing from the Adelaide Convention Centre at 6.30pm sharp

Australasian Faculty of Public Health Medicine Dinner

Date: Monday, 16 May 2016
Time: 7pm – 10pm
Venue: River Cafe
Cost: AUD \$85 per person (does not include beverages, cash bar available)
Transfers: Departing from the Adelaide Convention Centre at 6.30pm sharp

Paediatrics and Child Health Division Dinner

Date: Monday, 16 May 2016
Time: 7pm – 10pm
Venue: Fig Tree, Adelaide Zoo
Cost: AUD \$157 per person
Transfers: Departing from the Adelaide Convention Centre at 6.30pm sharp

RACP Congress Gala Dinner

Date: Tuesday, 17 May 2016
Time: 6.30pm for 7pm until midnight
Venue: Panorama Ballroom, Adelaide Convention & Exhibition Centre
Cost: Included in all full registrations.
Day registration and guest tickets: AUD \$165

Oration Speakers

Orations are steeped in tradition at RACP Congress, being named after pioneers of medical education and the practice of specialty medicine throughout Australia and New Zealand. Through the delivery of the Oration, speakers are able to pay homage to those after whom each Oration is named and recognise the great gains that continue to be made in their memory for the future.

This year the College is pleased to host the following distinguished guests to present the 2016 Orations. Guest who are also highly recognised for their outstanding service to various fields including medicine, education and research:

- Ferguson-Glass Oration – Professor William Ivan Glass
- Priscilla Kincaid-Smith Oration – Professor John Mills
- Cottrell Memorial Lecture – Professor John Chalmers
- Howard Williams Oration – Professor Dinah Reddihough
- Redfern Oration – Dr Sue Morey

Ferguson-Glass Oration

Professor William Ivan Glass



Professor William Ivan Glass graduated from the University of Otago in 1956 and two years later, set sail for London. He arrived with his wife, his bags, no job and nowhere to live. His mentor at the time, Dr Chris Wood, Senior Lecturer in

Occupational Health at the London School of Hygiene and Tropical Medicine advised that he enrol there. Bill became a Member of the Faculty of Occupational Medicine in the UK in 1978 and the rest is history.

Priscilla Kincaid-Smith Oration

Professor John Mills



Professor John Mills is an internationally-respected physician, scientist and businessman. In addition to his Emeritus Professorship at Monash University he holds professorial positions at RMIT and the University of California, San Francisco

(UCSF). He is the Director of Research and Development at TissuPath Specialist Pathology, a Consulting Physician at The Alfred Hospital, Chairman of the Research Program and Research Advisory Committee of the Prostate Cancer Foundation of Australia (PCFA) and a non-executive director of GBS Venture Partners Pty Ltd.

Cottrell Memorial Lecture

Professor John Chalmers



Professor John Chalmers AC FAA has an outstanding record in hypertension research, both fundamental and clinical. His groundbreaking research on the role of the brain in the development of hypertension led to his election to Fellowship of the Australian

Academy of Science and helped establish Flinders University as a leading international centre in hypertension and neuroscience research.

His studies on the treatment of high blood pressure for the prevention of heart attack and stroke has changed the way patients are treated throughout the world. His work has been recognised through many awards including the Welcome Medal, the RT Hall Prize of the Cardiac Society of Australia and New Zealand, and the Volhard Medal of the International Society of Hypertension.

Professor Chalmers' contribution to medical science has been acknowledged through the award of many Honorary Doctoral degrees and extensive appointments on national and international boards and advisory committees. He was appointed a Companion in the Order of Australia (AC) in 1991 and awarded the Centenary Medal in 2003 in recognition of services to medical science and to Australian society.

Professor Chalmers remains an active researcher at The George Institute Australia, where he holds the title of Senior Director. He is a principal investigator on many research grants and steering committees for major studies, mentors young clinical researchers from around the world, and continues to publish and lecture prolifically.

Howard Williams Oration Professor Dinah Reddihough



Professor Dinah Reddihough is a paediatrician involved in the clinical care of children with disabilities, in particular cerebral palsy. She is the Group Leader of Developmental Disability and Rehabilitation Research at the Murdoch Childrens Research

Institute. Professor Reddihough was the Director of the Royal Children's Hospital's Department of Developmental Medicine between 1986 and 2011 and is an Honorary Professorial Fellow in the University of Melbourne.

Professor Reddihough is actively involved in teaching and supervising undergraduate and postgraduate students, and has contributed to a number of community organisations that assist people with disabilities.

Professor Reddihough was responsible for founding the Australasian Academy of Cerebral Palsy and Developmental Medicine, a multidisciplinary organisation committed to advancing knowledge about physical disability in childhood by conducting scientific meetings and fostering research and evidence based practice. She established the Centre for Developmental Disability Research named 'Solve! At the RCH'. This highly successful group developed a strategic plan and obtained funding which led to the establishment of the Apex Chair in Developmental Medicine in 2011, the first Chair in Developmental Medicine in Australia.

Redfern Oration Dr Sue Morey



Dr Sue Morey worked as a physician in General and Addiction Medicine at Royal Prince Alfred Hospital while Head of the Division of Community and Allied Services. She gained a Master of Public Health from Harvard University, and was Chief Health

Officer of NSW for six years. She was the Foundation President of the Faculty of Public Health Medicine. She was a member of the Doherty Inquiry into Medical Education and the Medical Workforce in 1987 and of the RACP Workforce Committee and the Rural Task Force for many years. Since 1994 she has worked as an independent consultant with an interest in rural medical education and the rural medical workforce. She was made a Member of the Order of Australia in 1999 for service to the development and promotion of improved public health services.



Are you seeking a new direction in 2016? Experience the Wavelength difference.

We understand you're passionate about your career. That's because we are too.

For almost 20 years, Wavelength has partnered with thousands of physicians across Australia, New Zealand and Singapore, providing expert job assistance, immigration services and specialist careers advice for the longterm.

As the region's largest medical recruitment specialist, we have a broad reach with long-established networks. We offer unrivalled and often exclusive access to some of the best locum and permanent physician jobs available.



**The Experts
in Medical
Recruitment**



**Roles in Australia,
New Zealand
and Singapore**



**Experienced
recruitment
specialists**



**A reputation
for service
excellence**

TALK TO US TODAY AND EXPERIENCE THE WAVELENGTH DIFFERENCE FOR YOURSELF

What are you waiting for? Call Hayley on 02 8353 9085 or email hyyeles@wave.com.au

Visit our website to find out more: www.wave.com.au



wavelength

SPECIALISTS IN MEDICAL RECRUITMENT

The best people, better placed for the best positions.

www.wave.com.au

Program

Colour Keys

-  **Adult
Medicine**
-  **Paediatrics &
Child Health**
-  **Environmental**
-  **Public
Health**
-  **Education**
-  **Policy &
Advocacy**

Monday 16 May 2016

Opening Sessions

Room: Hall L

8.15am – 10am

Welcome to Country

Opening address

*His Excellency the Honourable Hieu Van Le AO
Governor of South Australia*

President's welcome

Laureate Professor Nicholas Talley, RACP President

Lead Fellow's welcome

Associate Professor Michael Gabbett

Priscilla Kincaid-Smith Oration

Professor John Mills AO

Launch of the RACP End of Life Care position paper

Laureate Professor Nicholas Talley, RACP President

10am – 10.30am

Morning Tea in Exhibition Area, Hall N&O and Judging of the Paediatric & Child Health Poster Prize

10am – 10.30am

AFOEM – Launch of the Ethical Guidelines – Associate Professor James Ross, Dr David Beaumont, Dr Greg Stewart

Room: Hall L

10am – 10.30am

Chapter of Community Child Health Annual Members' Meeting

Room: Panorama Room 2

Monday 16 May 2016

<p>Adult Medicine – Stream 1 Rooms: City Rooms 1 & 2</p>	<p>Adult Medicine – Stream 2 Rooms: Hall M</p>	<p>Paediatrics & Child Health – Stream 1 Rooms: Panorama Room 2</p>	<p>Paediatrics & Child Health – Stream 2 Rooms: Riverbank Room 6</p>	<p>AFOEM Stream Room: Hall L</p>	<p>AFPHM Stream Rooms: City Rooms 3 & 4</p>	<p>Physician’s Professionalism & Performance Room: Riverbank Room 7</p>	<p>Policy & Advocacy Stream Room: Panorama Room 1</p>
<p>10.30am – 11am</p> <p>Clinical update ASCIA Recent advances in clinical immunology and allergy <i>Dr William Smith</i></p>	<p>10.30am – 12pm</p> <p>Panel discussion Multidisciplinary care in Indigenous health A hypothetical case study, which will explore how to deliver effective and culturally safe and appropriate care to Indigenous people. <i>Mr Peter Buckskin</i> <i>Dr Danny de Lore</i> <i>Ms Celia Harms</i> <i>Dr Kali Hayward</i> <i>Dr George Laking</i> <i>Dr Tamara Mackean</i></p> <p>Session partnered with Policy and Advocacy</p>	<p>10.30am – 12.15pm</p> <p>The Little Heroes Centre for Innovation and Robotics <i>Dr Ray Russo</i></p> <p>12.15pm – 12.30pm</p> <p>RACP Trainee Research Awards for Excellence – Regional Finalist PREMM: Preterm early massage by the mother – the effects of massage in very preterm infants <i>Dr Melissa Lai, QLD</i></p>	<p>10.30am – 12.30pm</p> <p>Rue Wright Memorial Award Presentations 10.40am – 10.55am Foetal alcohol spectrum disorders in Australia: provisional findings of prospective national case surveillance <i>Dr Marcel Zimmer</i> 10.55am – 11.10am The parental immunisation needs and attitudes (PINA) survey in hospital paediatric clinics (PINA-H) and community maternal and child health centres (PINA-C) in Melbourne <i>Dr Jessica Costa-Pinto</i></p>	<p>10.30am – 12.30pm</p> <p>PTSD – What are the knock on effects? 10.35am – 11.15am UK military veterans and the military family <i>Professor Nicola Fear</i> 11.15am – 11.45am PTSD in train drivers – from a rail industry perspective <i>Mr Barry Walding</i> 11.45am – 12.15pm Childhood trauma, adult pain <i>Dr Michelle Atchison</i></p>	<p>10.30am – 12.25pm</p> <p>John Snow Scholarship Regional Finalists 10.40am – 10.55am Child and family centres and healthcare access – a pilot cohort study <i>Miss Eliza Nolan, University of Tasmania</i> 10.55am – 11.10am Surveillance and epidemiology of blood borne viral hepatitis in Australia: 21 years of the National Notifiable Disease Surveillance System <i>Ms Aleece MacPhail, University of Melbourne</i></p>	<p>10.30am – 12.30pm</p> <p>Professional behaviour in the workplace This interactive session will focus on examining the professional behaviour of Fellows and trainees of the College. Through a combination of presentations, panel discussion and scenarios it explores some behaviours which transgress those expected of members of the College such as bullying, discrimination, sexual harassment and more common negative behaviours such as undermining. Fellows, trainees and experts in the field will clarify what constitutes poor professional behaviours, what leaders can do to change a culture which is considered toxic and, from a trainee and Fellow perspective, what to do if they experience bullying behaviour from their supervisor or another colleague. This session will provide an update on action the College is taking to prevent and remediate such behaviour and clarify the role of individuals and local health settings in working together to build positive and healthy work and learning cultures.</p>	<p>10.30am – 12.30pm</p> <p>Evolve initiative: the latest on ‘What not to do’ Clinical updates on the evidence behind changes to clinical practice to reduce unnecessary interventions, focusing on recommendations that have direct relevance to other specialities and exploring why the practice might still be so prevalent and effective strategies to appropriately reduce their use.</p> <p>Session chairs <i>Dr Catherine Yelland</i> <i>Associate Professor Nick Buckmaster</i></p> <p>Gastroenterology <i>Professor Anne Duggan</i></p> <p>Rheumatology <i>Dr Catherine Hill</i></p> <p>Clinical pharmacology <i>Dr Jenny Martin</i></p> <p>Palliative medicine <i>Dr Doug Bridge</i></p> <p>Genetics <i>Associate Professor Julie McGaughran</i> “The sooner and more comprehensively this list is used the better” (Palliative Medicine). “ESA members have been enthusiastic (and) see the advantages to patients and the community” (Endocrine Society of Australia)</p>

Monday 16 May 2016

<p>12pm – 12.30pm Precision medicine in cancer treatment: precise landing for a cancer moonshot <i>Professor Richard Pestell</i> Recipient of the Eric Susman Prize 2015</p>	<p>12pm – 12.15pm RACP Trainee Research Awards for Excellence – Regional Finalist Silent and apparent neurological injury in Transcatheter Aortic Valve Implantation Study (SANITY) <i>Dr Jonathan Fanning, QLD</i></p>	<p>12.15pm – 12.30pm RACP Trainee Research Awards for Excellence – Regional Finalist Comparison of contemporary risk scores for predicting mortality and morbidity after aortic valve replacement <i>Dr Tom Wang</i></p>	<p>Continued PREMM: Preterm early massage by the mother – the effects of massage in very preterm infants</p>	<p>Continued Rue Wright Memorial Award presentations 11.10am – 11.25am Demographic predictors of family functioning and its change over the first five years post-partum: findings from the healthy beginnings trial <i>Dr Sirthu Vivekanandarajah</i></p>	<p>11.25am – 11.40am Adolescent incontinence <i>Dr Thet Soe</i></p>	<p>Continued PTSD – What are the knock on effects? 12.15pm – 12.30pm Panel discussion with all session speakers <i>Professor Nicola Fear</i> <i>Mr Barry Walding</i> <i>Dr Michelle Atchison</i></p>	<p>Continued John Snow Scholarship Regional Finalists 11.10am – 11.25am Potential efficiency gains in Australian primary care: a review <i>Mr Shaun Vaughn, Australian National University</i></p>	<p>11.25am – 11.40am Whakawhangaungatanga and antiracist research praxis <i>Ms Su'Ad Muse, University of Otago</i></p>	<p>Continued Professional behaviour in the workplace</p>	<p>Continued session: "A smart, succinct, evidence-based 'list of five points' with direct clinical relevance" (Sexual Health Medicine).</p>
--	---	--	--	---	--	---	---	---	--	--

Monday 16 May 2016

Continued Precision medicine in cancer treatment: precise landing for a cancer moonshot	Continued Comparison of contemporary risk scores for predicting mortality and morbidity after aortic valve replacement	Continued PREMM: Preterm early massage by the mother – the effects of massage in very preterm infants	Continued Rue Wright Memorial Award presentations 11.40am – 11.55am Brief school-entry sleep intervention improves child outcomes: randomised controlled trial <i>Associate Professor Harriet Hiscock</i> 12.15pm – 12.30pm RACP Trainee Research Awards for Excellence – Regional Finalist Epidemiology of intussusception in New Zealand pre rotavirus vaccination <i>Dr Bronwyn Rosie, New Zealand</i>	Continued PTSD – What are the knock on effects?	Continued John Snow Scholarship Regional Finalists 11.55am – 12.10pm Trachoma mass drug administration and health promotion in the Western Australian goldfields <i>Miss Matilda-Jane Oke, University of Notre Dame Fremantle</i> 12.10pm – 12.25pm Melanoma in the news: a discourse analysis of articles in the Australian newspaper <i>Ms Olivia Charlton, University of Notre Dame Sydney</i>	Continued Professional behaviour in the workplace	Continued Evolve initiative: the latest on 'What not to do'
---	--	---	--	---	---	---	---

12.30pm – 1.30pm

Lunch in Exhibition Area, Hall N&O

12.30pm – 1.30pm

RACP Annual General Meeting

Room: Riverbank Room 5

Monday 16 May 2016

<p>Adult Medicine – Stream 1 Room: City Rooms 1 & 2</p> <p>1.30pm – 2pm</p> <p>Clinical update MoGA Advances in medical oncology and the rapidly developing area of immune-oncology Professor Michael Brown</p> <p>2pm – 3.30pm</p> <p>Clinical update ASID Infectious diseases Dr Emily Rowe</p> <p>2.30pm – 3pm</p> <p>Clinical update ESA Recent advances / controversies in clinical endocrinology Associate Professor Marlon Burt</p>	<p>Adult Medicine – Stream 2 Room: Hall M</p> <p>1.30pm – 3pm</p> <p>Panel discussion Clinical genetics and its impact across clinical disciplines</p> <p>Improved diagnosis using Next Generation Sequencing Dr Eric Haan</p> <p>Genetic testing for genetic cardiac disorders – is it useful? Professor Chris Semserian</p> <p>Genetic testing for monogenic forms of diabetes improves diagnosis and treatment Dr Nicola Poplawski</p>	<p>Paediatrics & Child Health – Stream 1 Room: Panorama Room 2</p> <p>1.30pm – 2.45pm</p> <p>Innovations in paediatrics</p> <p>Complex Care Coordinators in Queensland: a dispersed model Dr Lynne McKinlay</p> <p>Fabio the FROG – an online children’s satisfaction surveyor Dr Pam Murphy</p> <p>Innovative technologies in paediatric burns Dr Bronwyn Griffin</p> <p>Writing an educational blog Dr Tessa Davis – “Don’t forget the bubbles”; and Dr Dairina Starmer – “C Foam”</p>	<p>Paediatrics & Child Health – Stream 2 Room: Riverbank Room 6</p> <p>1.30pm – 3pm</p> <p>Sexual Health Workshop Staying safe – sex and the under sixteens: an interactive case based workshop</p> <p>After a brief introduction, we will present four different cases of sexually active teenagers and discuss the sexual and reproductive issues faced by these young people and the role paediatricians play in supporting them.</p> <p>This will be an interactive session where participants will be given the opportunity to actively engage in the discussion. Dr Sarah Martin Dr Rachel Skinner Dr Terrence Donald</p>	<p>AFOEM Stream Room: Hall L</p> <p>1.30pm – 3.35pm</p> <p>Ramazini Prize presentations</p> <p>1.35pm – 1.50pm Health demographics of prospective FIFO mining workers in regional Australia Dr Clare Wood</p> <p>1.50pm – 2.05pm Is lung function testing always required in offshore oil exploration workers’ Fitness for Work (FFW) assessment? Dr Andrew McNeill</p>	<p>AFPHM Stream Room: City Rooms 3 & 4</p> <p>1.30pm – 3.40pm</p> <p>Gerry Murphy Prize presentations</p> <p>1.40pm – 1.55pm Geospatial mapping of disadvantage in Sydney Local Health District Dr Katherine Todd, NSW</p> <p>1.55pm – 2.10pm Evaluation of the effectiveness and health outcomes of opportunistic school health checks in a remote setting Dr Alister Keyser, QLD</p>	<p>Physician’s Professionalism & Performance Room: Riverbank Room 7</p> <p>1.30pm – 3pm</p> <p>Mental health of physicians – a panel discussion In this session our panel of experts will discuss the current mental health issues facing physicians. The session will open with beyondblue sharing the findings from their recent National Mental Health Survey of Doctors</p> <p>Facilitator: Associate Professor Michael Gabbett</p> <p>Speakers: Professor Michael Baigent Dr Geoff Toogood Dr Mick O’Keefe</p>	<p>Education Stream 1 Room: Riverbank Room 8</p> <p>1.30pm – 3pm</p> <p>Workshop 2 – SPDP Part 1. Teaching and learning in healthcare settings Dr David Everitt Dr Carolyn Edmonds</p>	<p>Education Stream 2 Room: Room L2</p> <p>1.30pm – 3pm</p> <p>Education renewal: balancing sustainability and quality A session focussed on outlining the significant program of education change at the College to improve the quality of training and to achieve a better balance of the number of trainees it can sustainably train.</p>	<p>Policy & Advocacy Stream Room: Panorama Room 1</p> <p>1.30pm – 3pm</p> <p>Integrated Care in practice: what’s working and why? Hear about a range of models of integrated care; what’s been shown to work and the benefits and the challenges of being delivered by a more patient-centred and multidisciplinary approach to healthcare.</p> <p>Beating diabetes together in Western Sydney Professor Glen Maberly</p> <p>A co-designed model of care for people with intellectual disability Dr Robert Leimer Anne Funke, Social Worker and NSW Carer of the Year 2014</p>
---	---	---	--	--	---	--	---	---	---

Continued Clinical update ESA: Recent advances / controversies in clinical endocrinology	Continued session: Genetic diagnosis – the family perspective <i>Dr Francois Chamalaun</i>	2.45pm – 3pm RACP Trainee Research Awards for Excellence – Regional Finalist Response to growth hormone therapy and gonadal pathology in 45,X/46,XY females <i>Dr Angela Timmus, NSW</i>	Continued Sexual Health Workshop Staying safe – sex and the under sixteens: an interactive case based workshop	Continued Ramazzini Prize presentations 2.05pm – 2.20pm Evaluating the effectiveness of the new certificates of capacity in improving population-based management of musculoskeletal injuries within the Western Australian workers compensation system <i>Dr Iyad Dayoub</i> 2.20pm – 2.35pm Geogenic iron exposure: acute respiratory conditions and infections among iron ore workers in Western Australia <i>Dr Catherine Hurworth</i>	Continued Gerry Murphy Prize presentations 2.10pm – 2.25pm Absolute risk of cardiovascular disease events in the Australian general population: population-based risk and treatment profiles <i>Dr Simon Crouch, VIC</i> 2.25pm – 2.40pm Improving Aboriginal and remote sexually transmitted infection rates in WA: worth the effort <i>Dr Mithilesh Dronavalli, WA</i> 2.40pm – 2.55pm Induction of labour trends in the Northern Territory 2001-2012, by Aboriginal status and purity <i>Dr Pasqualina Coffey, NT</i>	Continued Mental health of physicians – a panel discussion	Continued Workshop 2 – SPDP Part 1. Teaching and learning in healthcare settings	Continued Education renewal: balancing sustainability and quality	Continued session: Monash watch: a first step towards managing complexity <i>Professor Dan Campbell</i>
---	---	---	---	--	--	--	--	---	--

Monday 16 May 2016

Continued Clinical update ESA: Recent advances / controversies in clinical endocrinology	Continued Panel discussion Clinical genetics and its impact across clinical disciplines	Continued Response to growth hormone therapy and gonadal pathology in 45,X/46,XY females	Continued Sexual Health Workshop Staying safe – sex and the under sixteens: an interactive case based workshop	Continued Ramazzini Prize presentations 2.35pm – 2.50pm Evaluating the difference in prevalence of alcohol and illicit drug use in the construction and oil and gas industry <i>Dr Heng Tan</i>	Continued Gerry Murphy Prize presentations 2.55pm – 3.10pm The first 100 patients of the Australian Capital Territory Adult Obesity Management Service <i>Dr Belinda Jones, ACT</i>	Continued Mental health of physicians – a panel discussion	Continued Workshop 2 – SPDP Part 1. Teaching and learning in healthcare settings	Continued Education renewal: balancing sustainability and quality	Continued Integrated Care in practice: What's working and why?
	Continued 2.50pm – 3.05pm Comparison of interventional outcomes of occupational musculoskeletal disorders <i>Dr Pravind Kumar</i>	Continued 3.05pm – 3.20pm Assessing lung function among selected female garment workers in Matale, Sri Lanka <i>Dr Bandula Bandara Herath-Mudiyanselage</i>		Continued 2.10pm – 3.25pm Talking story: a coordinated approach to Aboriginal children's ear health <i>Dr Jessica Leonard, SA</i>	Continued 3.25pm – 3.40pm An outbreak of paralytic shellfish poisoning in Tasmania <i>Dr Laura Edwards, TAS</i>				

Monday 16 May 2016

Continued Clinical update ESA: Recent advances / controversies in clinical endocrinology	Continued Panel discussion Clinical genetics and its impact across clinical disciplines	Continued Response to growth hormone therapy and gonadal pathology in 45,X/46,XY females	Continued Sexual Health Workshop Staying safe – sex and the under sixteens: an interactive case based workshop	Continued Ramazzini Prize presentations 3.20pm – 3.35pm Risk perception and communication following an exposure event at a wood treatment plant: a before and after study Dr Scott Newburn	Continued Gerry Murphy Prize presentations	Continued Mental health of physicians – a panel discussion	Continued Workshop 2 – SPDP Part 1. Teaching and learning in healthcare settings	Continued Education renewal: balancing sustainability and quality	Continued Integrated Care in practice: What's working and why?
3pm – 3.30pm Afternoon Tea in Exhibition Area, Hall N&O									
Adult Medicine – Stream 1 Room: City Rooms 1 & 2	Adult Medicine – Stream 2 Room: Hall M	Paediatrics & Child Health – Stream 1 Room: Panorama Room 2	Paediatrics & Child Health – Stream 2 Room: Riverbank Room 6	AFOEM Stream Room: Hall L	AFPHM Stream Room: City Rooms 3 & 4	Physician's Professionalism & Performance Room: Riverbank Room 7	Education Stream Room: Riverbank Room 8		
3.30pm – 3.45pm	3.30pm – 5pm	3.30pm – 5pm	3.30pm – 5pm	4.05pm – 5.40pm	4pm – 5pm	3.30pm – 5pm	3.30pm – 5pm		
RACP Trainee Research Awards for Excellence – Regional Finalist Antibiotic allergy and the use of restricted antibiotics Dr Jennifer O'Hern, TAS	Panel discussion Understanding the impact of the microbiome on health and disease and opportunities for intervention Dr Geraint Rogers Professor Steve Wesselingh Associate Professor David Lynn	NDIS: an opportunity for physicians, paediatricians and our patients The National Disability Insurance Scheme (NDIS) is the most significant reform of disability services in Australia in decades. Physicians and paediatricians will have patients in the NDIS, and will need to be equipped to advocate for these patients within this system. Whilst the NDIS is not designed to fund health services, this session will explore the implications of the scheme for the health of patients with disabilities. It will also feature an update on the work the RACP is doing to prepare for the rollout of the NDIS.	Assessment and management of childhood and neglect – with a child protection focus	Free papers 4.05pm – 4.35pm Hearing conservation in the primary aluminium industry Dr Michael Donoghue	Social determinants of health Sir Harry Burns	Consumer engagement and patient-centred care	Workshop 2 – SPDP Part 1 Teaching and learning in healthcare settings Dr David Evereff Dr Carolyn Edmonds		

Monday 16 May 2016

<p>3.45pm – 4pm RACP Trainee Research Awards for Excellence – Regional Finalist Gestational diabetes is associated with a pro-inflammatory T cell phenotype <i>Dr Angela Sheu, NSW</i></p>	<p>Continued Panel discussion Understanding the impact of the microbiome on health and disease and opportunities for intervention</p>	<p>Continued session: NDIS in a land area three times the size of Britain <i>Dr Nigel Stewart</i> Building the plane whilst flying it – Barwon Health/ McKellar Centre's test flight of the NDIS <i>Dr Michael Bennett</i> RACP-NDIS working together to deliver optimal health care for adults with developmental disability <i>Dr Robyn Wallace</i> Session partnered with Policy and Advocacy 4.45pm – 5pm</p>	<p>3.30pm – 4pm Introduction – RACP Child Protection Policy – Move towards competency based training in RACP EPAs – The Child Protection Long Case – Case examples: setting the scene <i>Dr Terry Donald</i> <i>Dr Jane Edwards</i></p>	<p>Continued Free papers 4.35pm – 5.05pm A rustle in the paddy fields: snakebite as an occupational disease of poor rural workers in Asia <i>Professor Julian White</i> 5.05pm – 5.20pm Thoracic outlet syndrome <i>Dr David Cullum</i> 5.20pm – 5.30pm ICOH 2021 Presentation <i>Professor Malcom Sim</i> 5.30pm – 5.40pm Ramazzini prize presentation</p>	<p>Continued Social determinants of health</p>	<p>Continued Consumer engagement and patient-centred care</p>	<p>Continued Workshop 2 – SPDP Part 1 Teaching and learning in healthcare settings</p>
<p>4pm – 4.30pm Clinical update Malnutrition <i>Professor Ian Chapman</i></p>		<p>RACP Trainee Research Awards for Excellence – Regional Finalist QuickWee: catching urine samples quickly from infants in the paediatric emergency department <i>Dr Jonathan Kaufman, VIC</i></p>	<p>3.45pm – 4.15pm Recognition of vulnerable families/child adversity and locating useful services and programs available for families in Australia <i>Ms Christine Gibson</i> 4.15pm – 4.45pm The spectrum of neglect, including its forensic assessment <i>Dr Jane Edwards</i></p>				
<p>4.30pm – 5pm Clinical update ACHSM/ASHA: evolution in sexual health medicine <i>Professor Basil Donovan</i></p>							

Monday 16 May 2016

Continued Clinical update AChSHM/ASHA: evolution in sexual health medicine Professor Basil Donovan	Continued Panel discussion Understanding the impact of the microbiome on health and disease and opportunities for intervention	Continued Quick-Wee: catching urine samples quickly from infants in the paediatric emergency department	Continued Assessment and management of childhood adversity and neglect – with a child protection focus 4.45pm – 5pm RACP Trainee Research Awards for Excellence – Regional Finalist Does providing dietary advice improve the ingestion of non-allergic nuts in children with existing nut allergies? A randomised controlled trial Dr Melissa Norman, SA	Continued Free papers	Continued Social determinants of health	Continued Consumer engagement and patient-centred care	Continued Workshop 2 – SPDP Part 1 Teaching and learning in healthcare settings
--	---	---	---	-----------------------	---	--	---

5pm – 6.30pm

Congress Welcome Reception in Exhibition Area, Hall N&O

7pm – Late

Paediatrics & Child Health Division Dinner

Adelaide Zoo, Fig Tree Room

7pm – Late

Australasian Faculty of Occupational and Environmental Medicine Dinner

Red Ochre Grill

7pm – Late

Australasian Faculty of Public Health Medicine Dinner

River Cafe

Tuesday 17 May 2016

7am – 8am

Avant – Sponsor's breakfast
Prescribing pitfalls: an update
 Professor Greg Whelan AM
 Room: Panorama Room 3



8.30am – 8.40am

Morning welcome
 Room: Hall L

8.40am – 9.20am

Ferguson-Glass Oration
 Professor William Glass

9.20am – 10am

Redfern Oration
 Dr Sue Morey

10am – 10.30am

Morning Tea in Exhibition Area, Hall N&O and judging of the Adult Medicine poster prizes

Adult Medicine – Stream 1
 Room: City Rooms 1 & 2

Adult Medicine – Stream 2
 Room: Hall M

Paediatrics & Child Health – Stream 1
 Room: Riverbank Room 5

Paediatrics & Child Health – Stream 2
 Room: Riverbank Room 6

AFOEM Stream
 Rooms: Hall L

AFPHM Stream 1
 Room: City Room 3

AFPHM Stream 2
 Room: City Room 4

Physician's Professionalism & Performance
 Room: Riverbank Room 7

Education Stream
 Room: Riverbank Room 8

Abstract presentations Stream 1 – Adult Medicine
 Room: Room L2

Abstract presentations Stream 2 – Paediatrics & Child Health
 Room: Room L3

10.30am – 11am

Clinical update ANZBMS
 Current and emerging anabolic therapies in the management of osteoporosis
 Professor Howard Morris

10.30am – 11am

Clinical update ASCEPT
 Hot topics in clinical pharmacology: deprescribing, repurposing of 'old' drugs, pharmacokinetics of medicinal cannabis and therapeutic drug monitoring (cancer drugs)
 Professor Jen Martin

10.30am – 12.30pm

Evolve Workshop for General Paediatrics
 Dr Sarah Dalton
 Dr Harriet Hiscock
Session partnered with Policy and Advocacy

10.30am – 12.15pm

Paediatrics and mental health
Review of findings from first National Child and Adolescent Mental Health Surveys
 Dr Michael Sawyer

10.30am – 12.30pm

Environmental issues
 10.30am – 11am
Maralinga and the British nuclear weapons tests in Australia – a lasting legacy
 Dr David Douglas

10.30am – 12.30pm

New approaches to tobacco control
 10.30am – 11.10am
Tobacco control in Australia: how low can we go?
 Emeritus Professor Simon Chapman

10.30am – 12.30pm

Early childhood health
 10.30am – 11.10am
 Dr Carol Bower
 11.10am – 11.50am
 Dr Fiona Arrey

10.30am – 12.30pm

Coaching
 Sue Sims
 Helen O'Grady

10.30am – 12.30pm

Basic Training curricula renewal – consultation

10.30am – 12.35pm

Oral abstract presentations
 10.35am – 10.55am
Familial pulmonary arterial hypertension (FPAH) at a tertiary referral unit – patterns in presentation and prognosis
 Dr Aaron Esmaili

10.30am – 12.15pm

Oral abstract presentations
 10.35am – 12pm
Engaging young people in a youth research advisory group
 Dr Pairina Caldwell

<p>11am – 11.30am Clinical update CSANZ Atrial fibrillation Professor Prashanthan Sanders</p>	<p>11am – 12.30pm Panel discussion post-intensive care syndrome Outcomes of critically ill patients presenting with sepsis Dr Yasmine Ali Abdelhamid</p>	<p>Continued session: Evolve is a part of a growing international movement to review medical practices and reduce the use of low-value interventions. This workshop will present the evidence behind several low-value clinical practices and seek the expertise of paediatricians to refine a Top 5 priority list for children.</p>	<p>Continued Paediatrics and mental health Siblings of children with a chronic condition: improving their mental health and well being Dr Kate Strahm</p>	<p>Continued Environmental issues 11am – 11.15am Blue light hazards Professor Dino Pisaniello 11.15am – 12pm Diesel engine exhaust Dr Rob McDonald Professor Tim Driscoll 12pm – 12.30pm Coal seam gas mining Dr Keith Adam</p>	<p>Continued New approaches to tobacco control 11.10am – 11.35am Jacqueline Bowden 11.35am – 12pm TBA 12pm – 12.30pm Q&A Panel</p>	<p>Continued Early childhood health 11.50am – 12.30pm Dr Yasmin Harman-Smith</p>	<p>Continued session: Facilitated by two expert coaches who have piloted the successful College coaching program for supervisors, this interactive session focuses on how to develop skills in coaching which can be used in a broad range of contexts including supervision, career development and time management</p>	<p>Continued Basic Training curricula renewal – consultation</p>	<p>Continued Oral abstract presentations 10.55am – 11.15am Characteristics of hip fracture patients with and without previous minimal trauma fractures: are we missing secondary prevention? Dr Armm Hasibul Haque 11.15am – 11.35am Te Whakan-gungu Rakau: an increased incidence of thyrotoxicosis in Maori Dr Jade Tamatea</p>	<p>Continued Oral abstract presentations 10.55am – 11.15am Polyethylene glycols with or without electrolytes for constipation in children: a network meta-analysis Dr Noel Cranswick 11.15am – 11.35am Improving attendance at vulnerable child clinics with a clinician phone call: a prospective audit Dr Ketaki Sharma</p>
<p>11am – 11.45am RACP Trainee Research Awards for Excellence – Regional Finalist Impact of a standardised patient observation and multi-tiered escalation response chart and new calling criteria on adverse patient outcomes Dr Alice O'Connell, SA</p>										

Tuesday 17 May 2016

<p>11.45am - 12pm RACP Trainee Research Awards for Excellence - Regional Finalist The Pleural Effusion And Symptom Evaluation (PLEASE) Study Dr Maree Azzopardi, WA</p>	<p>Continued Panel discussion post-intensive care syndrome</p>	<p>Continued Evolve Workshop for General Paediatrics</p>	<p>12.15pm - 12.30pm RACP Trainee Research Awards for Excellence - Regional Finalist Identification of health risk behaviours among adolescent refugees resettling in Western Australia Dr Kajal Hirani, WA</p>	<p>Continued Environmental issues</p>	<p>Continued New approaches to tobacco control</p>	<p>Continued Early childhood health</p>	<p>Continued Coaching</p>	<p>Continued Basic Training curricula renewal - consultation</p>	<p>Continued Oral abstract presentations 11.35am - 11.55am Outcomes are superior in patients with acute stroke from New Zealand versus rest of world: data from the efficacy of nitric oxide in stroke (ENOS) trial Dr Michael Furlong</p>	<p>Continued Oral abstract presentations 11.35am - 11.55am Influenza related complications and deaths in Australian children: seasonal surveillance 2008-2015 Dr Yvonne Zurynski</p>
<p>12pm - 12.30pm Clinical update Unmet need of paediatric cancer survivors Dr Heather Tapp</p>									<p>11.55am - 12.15pm Ethnic disparity in patients who are euthyroid following both surgery and radioactive iodine for Graves' disease Dr Jade Tamatea</p>	<p>11.55am - 12.15pm Adequacy of palliative care in a single tertiary neonatal unit Dr Deborah Gilmour</p>
									<p>12.15pm - 12.35pm Under-dosing of NOACs for AF: old habits die hard Dr Ann Cheng</p>	

Tuesday 17 May 2016

12.30pm – 1.30pm
Lunch in Exhibition Area, Hall N&O

12.30pm – 1.30pm
Paediatrics & Child Health Division Annual Meeting
Room: Panorama Room 2

12.30pm – 1.30pm
Australasian Faculty of Public Health Annual Members Meeting
Room: City Room 3

12.30pm – 1.30pm
Australasian Faculty of Occupational and Environmental Medicine Annual Members Meeting
Room: Hall L

Adult Medicine – Stream 1
Room: City Rooms 1 & 2

Adult Medicine – Stream 2
Room: Hall M

Paediatrics & Child Health – Stream 1
Room: Riverbank Room 5

Paediatrics & Child Health – Stream 2
Room: Riverbank Room 6

AFOEM Stream
Room: Hall L

AFPHM Stream 1
Room: City Room 3

AFPHM Stream 2
Room: City Room 4

Physician's Professionalism & Performance
Room: Riverbank Room 7

Education Stream
Room: Riverbank Room 8

Abstract Presentations Stream 1 – Adult Medicine
Room: Room L2

Policy & Advocacy Stream
Room: Room L3

1.30pm – 2pm
Clinical update IMSANZ
General medicine update
Dr Patrick Russell

1.30pm – 3pm
Panel discussion
Misconceptions regarding allergy and non-allergy drug reactions
Professor Bill Huddle
Dr William Smith Associate
Professor Michaela Lucas

1.30pm – 3pm
Lessons in leadership; leading change in healthcare
Dr John Wakefield
Dr Jonny Taitz
Sir Harry Burns

1.30pm – 2.50pm
Subdural haematoma in children aged <2 years – deciding on the cause of injury
Dr Susan Marks
1.50pm – 2.20pm
Female genital mutilation and cutting children resident in Australia
Professor Elizabeth Elliott

1.30pm – 3pm
Learning experiences of an OEP
1.35pm – 1.40pm
Case presentation
Dr Kar Loong Ng
1.40pm – 2.05pm
How anger can corrupt our opinion, and other emotional biases
Dr Carolyn Semmler

1.30pm – 3pm
Big data and data linkage
1.30pm – 2pm
Professor Louisa Jorm
2pm – 2.20pm
Professor James Harrison
2.20pm – 2.40pm
Felicity Flack
2.40pm – 3pm
Q&A Panel

1.30pm – 3pm
Anti-microbial resistance
Professor Ben Howden

1.30pm – 3pm
Decision making
Ms Kristine Gibson, RACP
Legal Counsel

1.30pm – 3pm
Workshop 3 – SPDP Part 1 Work-based learning and assessment
Associate Professor Peter Davoren
Dr Darren Roberts

1.30pm – 3pm
Oral abstract presentations
1.35pm – 1.50pm
Acute kidney injury in hospitalised elderly medical patients: types, incidence, risk factors and relation to clinical outcomes
Dr Nalaja Soerjadi

1.30pm – 3pm
Physician as advocate – exploring power dynamics in healthcare
An interactive session with participants encouraged to reflect on power in the policy making process, including their 'authority' and their 'legitimacy' as physician advocates

2pm – 2.30pm
Clinical update AChAM
Addiction medicine
Dr Matthew Frei

1.30pm – 3pm
Clinical update
Clinical registries
Professor John McNeil

Continued Clinical update Clinical registries	Continued Panel discussion Misconceptions regarding allergy and non-allergy drug reactions	Continued session: "Not all change is improvement but all improvement requires change". Clinical leadership is key to improving care for our patients, but leadership roles can be complex and challenging. In this session we will hear from three renowned international leaders about their leadership challenges and lessons they have learned in implementing change	Continued session: 2.20pm – 2.40pm Serious injury due to ingested or inserted batteries in children Dr Ruth Barker	Continued How anger can corrupt our opinion, and other emotional biases 2.05pm – 2.30pm How can qualitative research help? Associate Professor Michael Shanahan	Continued Q&A Panel	Continued Antimicrobial resistance	Continued Decision making	Continued Workshop 3 – SPDP Part 1 Work-based learning and assessment	Continued Oral abstract presentations 1.50pm – 2.10pm The impact of unrecorded ancillary disease burden on routine hospital mortality coding statistics Dr Mahwash Ikhtlaq and Prof Robert MacFadyen	Continued session: The session will focus on equipping participants with practical advocacy skills including; key questions to guide the development of an advocacy strategy; an understanding of the importance of framing an issue; and some take-home advocacy tips.
			2.40pm – 3pm Are we there yet? Seatbelt related injuries in children aged <13 years Dr Yvonne Zurynski	2.30pm – 2.50pm Learning from our peers Dr Peter Jezukaitis					2.10pm – 2.30pm Palliative care orders, ancillary disease burden and impact on hospital mortality coding statistics Dr Mahwash Ikhtlaq and Prof Robert MacFadyen	
				2.50pm – 3pm Panel Q&A Dr Kar Loong Ng Dr Carolyn Semmler Associate Professor Michael Shanahan Dr Peter Jezukaitis						

Tuesday 17 May 2016

Continued Clinical update Clinical registries	Continued Panel discussion Misconceptions regarding allergy and non-allergy drug reactions	Continued Lessons in leadership; leading change in healthcare	Continued Are we there yet? Seatbelt related injuries in children aged <13 years	Continued Panel Q&A	Continued Antimicrobial resistance	Continued Decision making	Continued Workshop 3 – SPDP Part 1 Work-based learning and assessment	Continued Oral abstract presentations 2.30pm – 2.50pm Appropriateness of transthoracic echocardiogram referrals in acute general medical inpatients Dr Abdullah Al Alawi	Continued Physician as advocate – exploring power dynamics in healthcare
3pm – 3.30pm Afternoon Tea in Exhibition Area, Hall N&O									
Adult Medicine – Stream 1 Room: City Rooms 1 & 2	Adult Medicine – Stream 2 Room: Hall M	Paediatrics & Child Health – Stream 1 Room: Riverbank Room 5	Paediatrics & Child Health – Stream 2 Room: Riverbank Room 6	AFOEM and AFPHM Combined Room: Hall L	Education Stream Room: Riverbank Room 8	Abstract presentations Stream 1 – Public Health and Occupational & Environmental Medicine Room: Room L2	Abstract presentations Stream 2 – Paediatrics & Child Health Room: Room L3	Abstract presentations Stream 2 – Paediatrics & Child Health Room: Room L3	Abstract presentations Stream 2 – Paediatrics & Child Health Room: Room L3
3.30pm – 4pm	3.30pm – 3.45pm	3.30pm – 4.45pm	3.30pm – 4.45pm	3.30pm – 5pm	3.30pm – 5pm	3.30pm – 5pm	3.30pm – 5pm	3.30pm – 4.30pm	3.30pm – 4.30pm
Clinical update AChPM/ ANZSPM Palliative medicine Associate Professor Gregory Crawford Dr Lawrence Palmer	RACP Trainee Research Awards for Excellence – Regional Finalist Dr Gowri Samarajah, VIC	Better and safer care for kids; high reliability in paediatric care Dr Andrew Hallahan Dr Annie Moulden	Trauma support Dr Nicole Williams Prof Kim Foster	Climate change/ planetary health Session partnered with Policy and Advocacy	Workshop 3 – SPDP Part 2 Work-based learning and assessment Associate Professor Peter Davoren Dr Darren Roberts	Oral abstract presentations 3.30pm – 3.50pm Heart failure after conventional large head metal-on-metal hip replacements in men Dr Marianne Gillam	Oral abstract presentations 3.30pm – 3.50pm Moving from paediatric to adult health services: transition experiences of young people with neuromuscular disorders Dr Yvonne Zurynski	Oral abstract presentations 3.30pm – 3.50pm Moving from paediatric to adult health services: transition experiences of young people with neuromuscular disorders Dr Yvonne Zurynski	Oral abstract presentations 3.30pm – 3.50pm Moving from paediatric to adult health services: transition experiences of young people with neuromuscular disorders Dr Yvonne Zurynski

Tuesday 17 May 2016

<p>4pm – 4.30pm Clinical update Myositis Dr Vidya Limaye</p>	<p>Continued session: The burden of diabetes on hospital services: impact on general internal medical inpatients at Western Health</p>	<p>4.30pm – 5pm</p>	<p>Clinical update Pulmonary hypertension Associate Professor Susanna Proudman</p>	<p>3.45pm – 4pm RACP Trainee Research Awards for Excellence – Regional Finalist Epidemiological investigation of an outbreak of sporotrichosis Dr Sarah McGuinness, NT</p>	<p>4.45pm – 5pm RACP Trainee Research Awards for Excellence – Regional Finalist Central venous catheter associated blood stream infection in Neonatal Intensive Care Unit – prediction and prevention Dr Gopakumar Hariharan, TAS</p>	<p>Climate change/planetary health 3.30pm – 3.55pm Professor Lynne Madden 3.55pm – 4.20pm Saving humanity involves a lot more than zero carbon emissions by 2050 Professor Peter Sainsbury 4.20pm – 4.35pm Dr George Laking 4.35pm – 5pm Q&A Panel</p>	<p>Continued Workshop 3 – SPDP Part 2 Work-based learning and assessment</p>	<p>Continued Oral abstract presentations 3.50pm – 4.10pm An Australian national prospective study of the incidence of juvenile onset recurrent respiratory papillomatosis Dr Daniel Novakovic 4.10pm – 4.30pm Mandatory desexing of dogs in South Australia: the evidence for preventing dog bites Dr Katrina D’Onise</p>	<p>Continued Oral abstract presentations 3.50pm – 4.10pm Survey of the use of Australasian paediatricians Dr Victoria McKay 4.10pm – 4.30pm Paediatricians caring for children with rare diseases: survey of current knowledge, practice and future educational needs Dr Arancha Gonzalez</p>	<p>Continued Oral abstract presentations 3.50pm – 4.10pm How can we better manage functional gastrointestinal disease? Dr Eushia Linedale 4.50pm – 5.10pm Secondary depression and employer-employee communication following injury Dr Andrew Harper</p>
--	--	----------------------------	---	--	---	--	--	---	---	--

Tuesday 17 May 2016

Continued Clinical update Pulmonary Hypertension									Continued Oral abstract presentations
4pm – 4.30pm Clinical update Management of diabetes <i>Associate Professor Stephen Stranks</i>									Continued Oral abstract presentations
4.30pm – 5pm									Continued Workshop 3 – SPDP Part 2 Work-based learning and assessment
Clinical update Management of hypertension <i>Dr. Arduino Mangoni</i>									Continued Climate change/planetary health
									Continued Central venous catheter associated blood stream infection in Neonatal Intensive Care Unit – prediction and prevention
									Continued Paediatric Advance Care Planning: physician experience, confidence and education in raising difficult discussions
									Continued Oral abstract presentations
									Continued Oral abstract presentations
6.30pm – late Congress Gala Dinner, Adelaide Convention Centre Room: Panorama Ballroom									

Wednesday 18 May 2016

7am – 8.30am

Professional leadership breakfast

Associate Professor Grant Phelps

Room: Panorama Room 3

8.30am – 8.40am

Morning welcome

Room: Hall L

8.40am – 9.20am

Cotterall Memorial Oration

Stroke and blood pressure: prevention and treatment

Professor John Chalmers

9.20am – 10am

Howard Williams Oration

Disability at the crossroads: improving the care of children with cerebral palsy

Professor Dinah Reddihough

10am – 10.30am

Morning Tea in Exhibition Area, Hall N&O

10.30am – 11.15am

Plenary address

Biological consequences of poverty and social chaos

Sir Harry Burns

11.30am – 12pm

Quality and safety

Professor Derek Bell

12pm – 12.20pm

Closing remarks

Laureate Professor Nicholas Talley

12.20pm – 1.30pm

Lunch in Exhibition Area, Hall N&O

What is MyCPD?

MyCPD is a tool that allows you to manage your continuing professional development as a Fellow of the RACP.

Access the MyCPD online program at: www.racp.edu.au/mycpd

Simplified MyCPD Framework

The College Education Committee has approved small changes to the 2016 MyCPD Framework.

- ✓ All CPD activities are now awarded credits based on an hourly rate, instead of set value.
- ✓ Preparation for teaching/publication/presentation has been merged with the event/publication in Category 1 to reduce the need to double claim.
- ✓ Grand rounds, journal clubs and other medical meetings have been moved to 'Group learning activities' in Category 2.
- ✓ The 50 credit cap has been extended to all categories to promote diversification of CPD activities.

MyCPD Framework 2016

CATEGORY	EXAMPLES	CREDITS
1 Educational Development, Teaching & Research	<ul style="list-style-type: none"> • Teaching, e.g. supervision, mentoring • Research - grant proposals and trials • Involvement in standards development • Reviewer • Writing Examination questions • Examining • Publication (including preparation) • Presentation (including preparation) 	1 credit per hour Maximum 50 credits per year
2 Group Learning Activities	<ul style="list-style-type: none"> • Seminars • Conferences • Workshops • Grand rounds • Journal clubs • Hospital and other medical meetings • Specialty specific scientific meeting 	1 credit per hour Maximum 50 credits per year
3 Self-Assessment Programs	<ul style="list-style-type: none"> • Medical Knowledge Self-Assessment Program (MKSAP) 	2 credits per hour Maximum 50 credits per year
4 Assessed Learning	<ul style="list-style-type: none"> • PhD studies • Formal postgraduate studies • Courses to learn new techniques, e.g. Advanced Life Support (ASL) or Advanced Paediatric Life Support (APLS) • Learner initiated and planned projects • Participation in the RACP Supervisor Professional Development Program 	3 credits per hour Maximum 50 credits per year
5 Practice Review & Appraisal	<ul style="list-style-type: none"> • Practice audits/Clinical audits • Peer review • Patient satisfaction studies • Institution audits, e.g. hospital accreditation • Incident reporting/monitoring, e.g. morbidity and mortality meetings 	3 credits per hour Maximum 50 credits per year
6 Other Learning Activities	<ul style="list-style-type: none"> • Reading journals and texts • Information searches, e.g. Medline • Audio/videotapes • Web-based learning 	1 credit per hour Maximum 50 credits per year



Record CPD on the go

Simply navigate to MyCPD on any internet-connected mobile device to access **MyCPD mobile**.

Continuing Professional Development

Committee

The Fellows Learning Support Unit and Continuing Professional Development Committee (CPDC) collaborate with many different parts of the College to create valuable new content for Fellows, including:

- Pomegranate podcasts
- Curated pages
- Journals
- eLearning resources
- Supervisor support workshops
- Congress videos

The Committee also works to develop resources that support EVOLVE, as well as webcasts for Fellows. A key goal of the CPDC is continual improvement of the MyCPD platform, to make it more user friendly and efficient. We appreciate and are interested in any feedback you might have, please email us at: MyCPD@racp.edu.au.

News for Australian Fellows

Revised MBA standards

The Medical Board of Australia (MBA) has revised their CPD Registration and Recency of Practice standards, taking effect from 1 October 2016. For further details please visit the MBA website <http://www.medicalboard.gov.au/News/2016-02-02-recency-of-practice.aspx>.

News for New Zealand Fellows

Memorandum of Understanding

The College recently signed a Memorandum of Understanding (MoU) with the Medical Council of New Zealand (MCNZ). This agreement formally requires The College to notify the MCNZ of Fellows who fail to complete their CPD requirements over two consecutive years. The College understands that our first report is expected at the end of the 2016 CPD cycle.

Poster Boards

The Poster displays will be located in the exhibition area of the Adelaide Convention Centre.

Poster titles with an asterix (*) are award finalists.

Poster #	Poster Author	Poster title
Adult Medicine		
PO01	Sangeetha Isaac	Epiploic appendagitis as a rare cause of abdominal pain in a middle aged woman
PO02	Liang Yong Chia	Sugars, slips and slurs: the diabetic patient with a hyperosmolar hyperglycemic state and osmotic demyelination syndrome
PO03	Aaron Gaekwad	Ethylene glycol poisoning treatment pre hospital and hospital: a case report
PO04	Aaron Gaekwad	Significant immune dysfunction – heavy metal culprit?: a case report
PO05	Genevieve Gabb	Idiopathic inflammatory myositis and statin exposure: a population based case control study
PO06	Genevieve Gabb	Cardiovascular disease, medications and heat: what precautionary advice is available?
PO07	Genevieve Gabb	National Heart Foundation Guideline for the diagnosis and management of hypertension in adults 2016
PO08	Mark Jordan	Improving the management and overall mortality of sepsis by implementing the 'sepsis six' recommendations
PO09	Jenny Caesar	Hypokalaemia: improving the investigation, management and monitoring of hypokalaemic medical inpatients
PO10	Emma Hack	Adherence to TGA Guidelines in clinical practice: a prospective one-day observational audit of metoclopramide prescription
PO11	Joshua Inglis	Penicillin allergy documentation in electronic health records
PO12	Krystal Song	Advance care planning in patients with brain tumours: a prospective cohort study
PO13	Matt Bain	Clinical frailty scale and simple blood tests at admission, are they predictors of length of stay?
PO14	Joe He	The cost of clinical practice and investigation of syncope in a South Australian hospital unit
PO15	Rohith Valsalan	Adherence to community acquired Pneumonia guidelines in Royal Hobart Hospital
PO16	Francis Albert Lo	Constant confusion: thyrotoxicosis and the persistent altered mental state
PO17	Francis Albert Lo	Gone low and wide awake: the alert hypoglycemic patient
PO18	Matt Reynolds	Choosing wisely: is there any benefit from ordering extractable nuclear antigens (ENAS) in patients with a negative ana?
PO19	James Hurley	The effect of adjunct steroid use in critical illness on mortality: is there a relationship with underlying risk?*
PO20	Michelle Papandony	A systematic review of consumer perceived health service needs related to osteoarthritis*
PO21	Cameron Schauer	Improving pulmonary embolism diagnosis: when will we learn?*
PO22	Leena Aggarwal	Telemetry in acute medical unit: is it as necessary and useful as thought?*
PO23	Sarah Newhouse	An unusual cause of membranous nephropathy*
PO24	Nicholas Sharrock	Characteristics of patients with infective endocarditis treated within a hospital in the home service*
PO25	Wei Ling Chiu	Prevalence and hospital outcomes of haematology and oncology patients with diabetes mellitus*
PO26	Yasmina Tashkent	An unusual adverse reaction associated with pramipexole*
PO27	Aaron Wong	The extended care unit – a feasible economic solution for longer term palliative inpatients*
PO28	Aaron Wong	Referral patterns to palliative care – An inpatient snapshot study*
PO29	Aaron Wong	Addressing resource allocation for advance care planning discussion in hospital*

Poster #	Poster Author	Poster title
PO30	Victoria Sasongko	Bringing the hospital to the home of our heart failure patients*
PO31	Raymond Wong	Increased mortality associated with omission of venous thrombo-embolism (VTE) prophylaxis in a rural intensive care unit*
PO32	Raymond Wong	Association of mortality and readmissions from after-hours discharge from an intensive care unit; four year snapshot from a rural intensive care unit*
PO33	Tiffany Foo	Diabetic ketoacidosis and sodium-glucose co-transporter 2 (SGLT2) inhibitors*
Australasian Faculty of Occupational and Environmental Medicine		
PO34	Peter Leggat	Perceptions of workplace health and safety in the Australian population
Paediatrics & Child Health		
PO35	Archana Makkar	Culture results for skin and soft tissue infections of children admitted to Mount Druitt Hospital
PO36	Sarah Cherian	Virtual educational resource for refugee health
PO37	Pankaj Handa	Portal vein thrombosis : a review at Tan Tock Seng Hospital, Singapore
PO38	Shakif Shakur	Paediatric bloodstream infections at an Australian metropolitan hospital from 2010 to 2014
PO39	Emily Fitzpatrick	The picture talk project: starting the conversation of research with remote Indigenous communities*
PO40	Meenakshi Rattan	Burden of meningococcal disease in infants at a tertiary paediatric hospital 2000 to 2013*
PO41	Vishal Kapoor	Predictors for retrieval in children admitted with bronchiolitis in an outer metropolitan centre: a nested case-control study*
PO42	Vishal Kapoor	Human errors in a paper based paediatric early warning system*
PO43	Vishal Kapoor	Effectiveness of high flow nasal cannula oxygen therapy in bronchiolitis patients admitted to a non-tertiary centre*
PO44	Harriet Hiscock	Trends in paediatric practice in Australia: 2008 and 2013 national audits from the Australian Paediatric Research Network*

Supporting, Encouraging and Acknowledging Excellence Through the RACP Foundation

The College, through the RACP Foundation, offers awards to cater for physicians at every stage of their research and education careers. Projects supported by these awards are renowned for being innovative and clinically applicable and the results contribute significantly to the medical research field. A number of the awards also represent partnerships undertaken between the RACP Foundation and other leading health organisations, such as the National Health and Medical Research Council (NHMRC), to provide the best funding opportunities for physicians.

The awards currently offered include:

- **Career Development Fellowships**, which support Fellows and trainees at the mid-stage of their research careers
- **Research Establishment Fellowships**, for those wishing to establish a career in research
- **Research Entry Scholarships**, to encourage Fellows and trainees who are commencing careers in medical research and undertaking a research higher degree
- **Research Development Grants**, to provide small amounts of funding to foster and encourage Fellows and trainees
- **Travel and Education Grants**, which cater for those wishing to pursue a postdoctoral fellowship, upskilling or further education overseas
- **RACP Indigenous Health Scholarships**, which provide a funded pathway through physician training for those who identify as being of Aboriginal, Torres Strait Islander, Māori or Pacific Islander heritage
- **International Grants**, which are offered to provide funding for international medical graduates or specialists who are intending to further their knowledge in fields of medical education and research.

The College offers and awards a wide range of prizes that recognise Fellows and trainees for outstanding contributions or achievements. These include:

- The John Sands College Medal
- The Eric Susman Prize
- RACP Medal for Clinical Service in Rural and Remote Areas
- RACP International Medal

Many of the awards are presented at the College Convocation ceremony; others are presented at the Congress Gala Dinner, Division or Faculty Dinner or Annual Scientific Meeting.

Overall, the College distributes over AUD\$2 million annually through Fellowships, Scholarships, Grants and Prizes to support, encourage and acknowledge Fellows and trainees.

More information regarding all awards is available on the RACP website at: www.racp.edu.au/about/racp-foundation-awards

Donors and Supporters Investing in Health

The investment in health from the College fellowship, the corporate sector, institutions and individual benefactors, is gratefully acknowledged as fundamental to the RACP Foundation's support and promotion of medical research and education initiatives.

A key priority of the College Research Strategy concerns researchers wishing to establish a career in research, and hence there is a focus on providing funding at the Research Establishment Fellowship level. A Fellowship from the College often provides that vital first research grant that leads to more substantial funding. Funding is provided by institutions, corporations and very importantly, through the Foundation donation given with the annual subscription.

Two specific initiatives which the RACP Foundation has recently commenced are Indigenous scholarships and International Grants.

In 2014, the College launched the RACP Indigenous Health Scholarship Program to provide financial support to Indigenous trainees both in Australia and New Zealand. These scholarships have been awarded to seven recipients to date.

The College has supported two international grants, providing financial assistance to international medical graduates to visit Australia to further their knowledge. Both were supported by their home institution and were sponsored by Fellows who had a philanthropic relationship with their institution. Although the amount of funding was very small, without it, these visits could not have occurred. These partnerships provide valuable opportunities to make a difference.

A list of donors and supporters can be found on the RACP website.

Contact Us

For more information about applying for an award, contributing to one of the RACP Foundation initiatives, or donating in general, please contact the RACP Foundation Office at foundation@racp.edu.au

General Information

ATM facilities

ATMs are located within the Adelaide Convention Centre in the foyers of both the West Entrance (Congress Foyer) and East Entrance.

Business Centre

There is no Business Centre located within the Adelaide Convention Centre. We recommend you use the business services of your hotel if required.

Emergency procedures

Please refer to the emergency procedures located on pages 37 and 38 of this handbook.

Emergency contacts

Fire, Police and Ambulance: 000.

Nearby hospital

Royal Adelaide Hospital, North Terrace, Adelaide. Approximately 2.5k from the Adelaide Convention Centre.

Wireless internet

Complimentary Wi-Fi is offered by the Adelaide Convention Centre. Please select the network 'ACC Free' on your device. No password is required. This service is capped at 75 MB per day and is designed for web browsing and checking web based emails. It is not designed for accessing VPNs or downloading large files.

Media

All Congress sessions are open to the media and as such, your presentation may be attended, or recorded by media representatives.

Media interest provides an excellent opportunity to advocate your work to a wider audience and have your field of health form part of the public agenda.

The RACP Media and Communications Unit will proactively engage with local and national media to promote RACP Congress 2016. The Media and Communications Unit may contact you to ascertain your availability for media requests during the Congress.

Please be advised that media may also wish to interview you before or after your presentation. A dedicated venue will be accessible for conducting media interviews and briefings.

If approached by media during Congress, initial enquiries should be direct to:

David Walsh
T: 0401 164 537
E: david.walsh@racp.edu.au

Social Media

Join the conversation:

 /theRACP
#RACPCongress16

 @theRACP
#RACPCongress16

Parking

If you are driving to the Adelaide Convention Centre offers two undercover car parking options with the North Terrace (400 spaces) and the Riverbank (500 spaces) car parks. Both are located directly under the Centre and are open 24 hours a day, 7 days a week. Clearance is 2.0 metres and automated payment stations accept credit/debit cards (1.5% surcharge for Visa, Mastercard, Diners and Amex). Both car parks are fitted with video surveillance camera systems and security patrols these areas.

The North Terrace parking is recommended for accessible parking as the allocated spaces are close to both the exit and the lifts.

Special diets

Please note that a special diet requirement is when a person chooses to omit certain foods or food groups from their diet on religious, ethical, moral or medical grounds. Provision will be made for food intolerances, Halal and Kosher requests, as well as vegetarian/vegan requests. Please note that while we make every effort to provide balanced, healthy meal options, requests for non-specific requirements, such as low glycaemic index or low fat food, cannot be guaranteed and pre-advised dietary requirements have been catered for are located in the Exhibition Hall on a specific 'Dietary Requirements' table.

Mobile phones

As a courtesy to fellow delegates and speakers, please ensure your mobile phones and/or pagers are switched off or turned to silent during conference sessions.

Intention to photograph

Delegates and others are advised that photographs may be taken during the conference and reproduced for promotional purposes.



Australian Government

Department of Health
Therapeutic Goods Administration

**Report adverse
events at
www.tga.gov.au**

Further information is
provided on a USB inserted
in your Congress satchel

Emergency & Evacuation Procedures

General requirements

Fire regulations

- All buildings are non smoking
- Keep all fire exits clear
- Do not store items in front of any fire exit or outside an exhibition stand perimeter including during set-up and breakdown.

Restricted areas

- Other halls or rooms may be in use – do not enter any halls or rooms unless you have authorisation
- Plant rooms are strictly prohibited unless during service evacuation
- Servery, Kitchen and Basement levels are prohibited unless you have authorisation.

Emergency procedure

If a fire is discovered

- Remove persons from danger
- Break the glass on any red Manual Call Point (MCP) or,
- Dial 6770 from any internal phone or,
- Dial 0000 from any internal phone
- Contain – close all doors and windows
- Evacuate – use designated emergency exits only
- Extinguish – only if safe to do so.

Emergency phone number

- Security 6770.

First aid facilities and reporting accidents

- Contact Floor Ambassadors 6771 or Security 6770
- First Aid room available
- Fill out visitor accident form immediately – available at Main Reception Desk.

Evacuation procedures

First tone – ‘ALERT’

Beep Beep Beep Beep

- Prepare to evacuate
- Secure materials as necessary
- Switch off all appliances
- Await further instructions.

Second tone – ‘EVACUATION’

Whoop Whoop

- Do NOT use lifts
- Follow staff instructions at all times
- Proceed to nearest emergency exit
- Proceed to closest emergency assembly point (refer to maps on the following page)
A: Riverbank adjacent to the Boat Shed or,
B: North Terrace under Morphett St Bridge
- Refer to Evacuation Plan on the following page.

LEVEL ONE



Evacuation Maps

First tone – ‘ALERT’

Beep Beep Beep Beep

- Prepare to evacuate
- Secure materials as necessary
- Switch off all appliances
- Await further instructions.

Second tone – ‘EVACUATION’

Whoop Whoop

- Do NOT use lifts
 - Follow staff instructions at all times
 - Proceed to nearest emergency exit and then to assembly area
- A: Riverbank adjacent to the Boat Sheds
 B: North Terrace under Morphet St Bridge

GROUND LEVEL

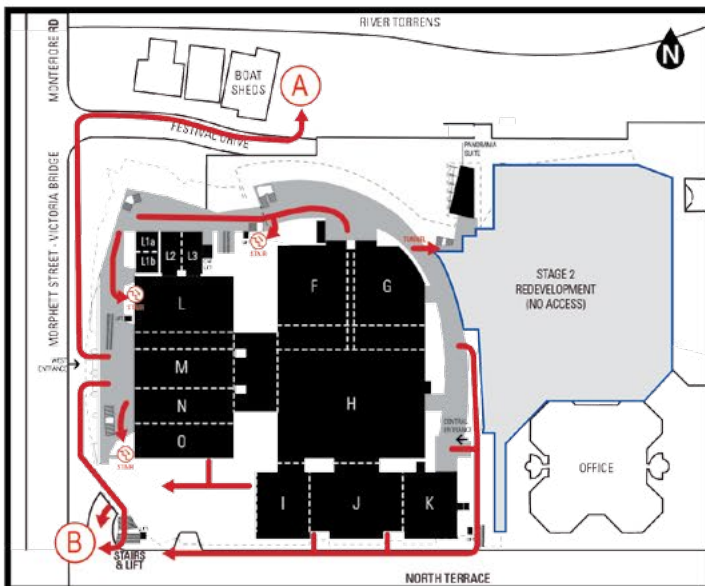

LOWER LEVEL ONE

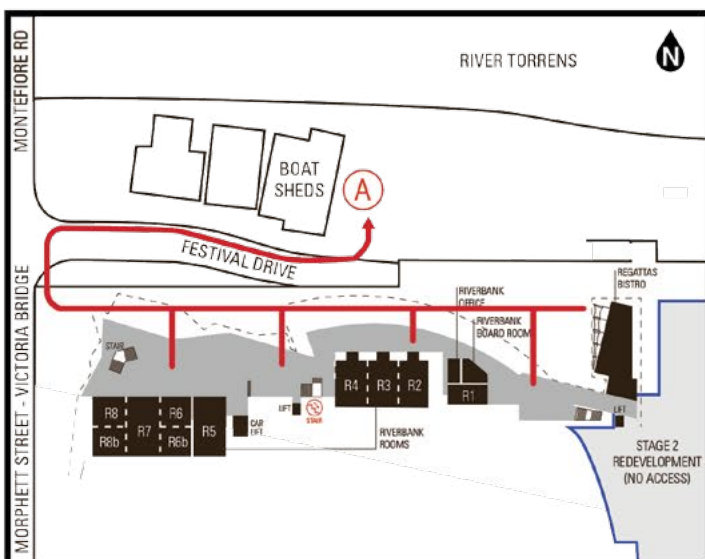

ADELAIDE CONVENTION CENTRE

Exhibition

The Exhibition Hall is located in Halls N and O at the west entrance to the Adelaide Convention Centre. The Congress Organising Committee extends an invitation to all delegates to visit the Exhibition during the Congress to meet the exhibitor representatives in attendance and to view the products and services on display.

Exhibition Opening Hours

Monday, 16 May
7.30am – 6.30pm

Tuesday, 17 May
7.30am – 5pm

Wednesday, 18 May
7.30am – 1.30pm



Venue Floor Plans

UPPER LEVEL

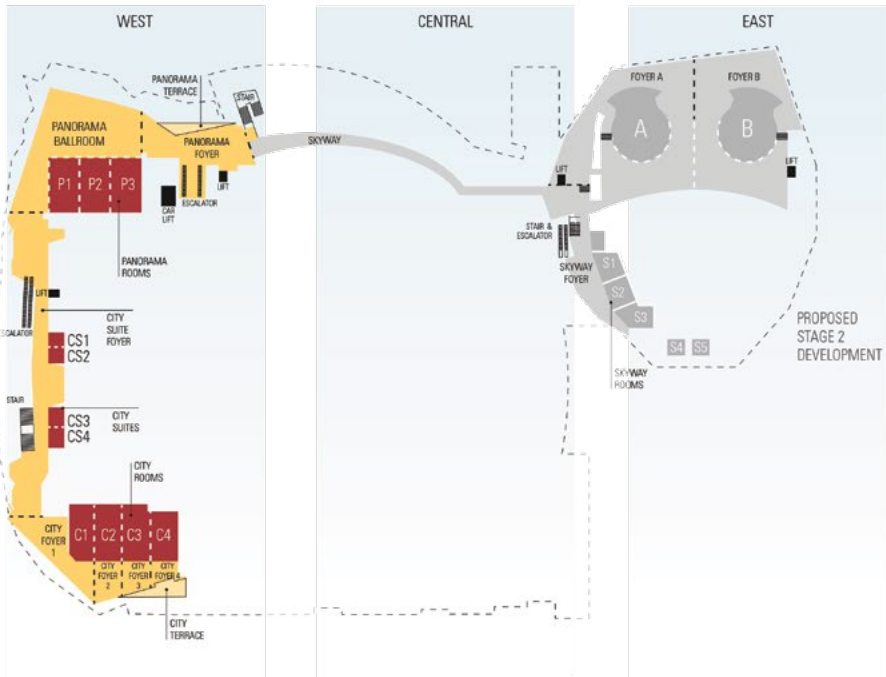

GROUND LEVEL



LOWER LEVEL

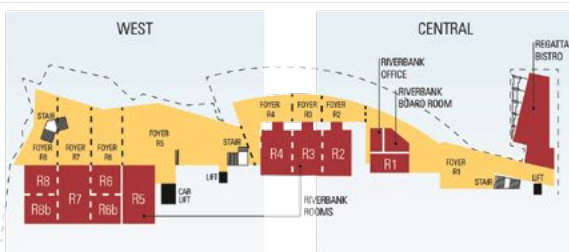

VVCS



Veterans and Veterans Families Counselling Service

A service founded by Vietnam veterans

VVCS provides free and confidential, nationwide counselling and support for war and service-related mental health and wellbeing conditions.

CALL 24 HOURS

1800 011 046

VETERANS | FAMILIES | ELIGIBLE ADF MEMBERS



Australian Government
Veterans and Veterans Families
Counselling Service

www.vvcs.gov.au 



RACP

Specialists. Together

EDUCATE ADVOCATE INNOVATE

The Royal Australasian College of Physicians
145 Macquarie Street (1300 69 7227 Australia)
Sydney NSW 2000 (0508 69 7227 New Zealand)
Australia www.racp.edu.au
1300 MYRACP RACPCongress@racp.edu.au



[/theRACP](#)
[#RACPCongress16](#)



[@theRACP](#)
[#RACPCongress16](#)